



## Alfa Laval TJ TZ-750 Rotary Jet Head - Portable

Fast, Effective Impact Cleaning



## TECHNICAL DATA

Lubricant: . . . . . Self-lubricating with the cleaning fluid  
Standard surface finish: . . . . . Ra 0.5µm exterior  
Flow rate: . . . . . 38 - 83 m<sup>3</sup>/h  
Max. throw length: . . . . . 30 - 40 m  
Min. required passage: . . . . . See dimension drawings

### Pressure

Working pressure: . . . . . 5 - 12 bar  
Recommended pressure: . . . . . 5 - 10 bar

### Cleaning Pattern

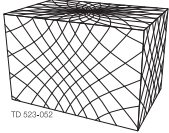

First cycle

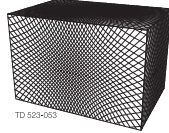

Full pattern

The above drawings show the cleaning pattern achieved on a horizontal vessel. The difference between the first cycle and the full pattern represents the number of additional cycles available to increase the density of the cleaning.

### Certificates

2.1 material certificate and ATEX.

### Standard Design

The choice of nozzle diameters can optimise jet impact length and flow rate at the desired pressure. As standard documentation, the Toftejorg TZ-750 can be supplied with a "Declaration of Conformity" for material specifications.

## PHYSICAL DATA

### Materials

316L (UNS S31603), 1.4401, PTFE, PVDF, Carbon, EFTE.

### Temperature

Max. working temperature: . . . . . 95°C  
Max. ambient temperature: . . . . . 140°C

### Weight

Portable: . . . . . 12.1 kg  
Fixed: . . . . . 3.6 kg

### Connections

Standard thread: . . . . . 2½" Rp (BSP), NPT



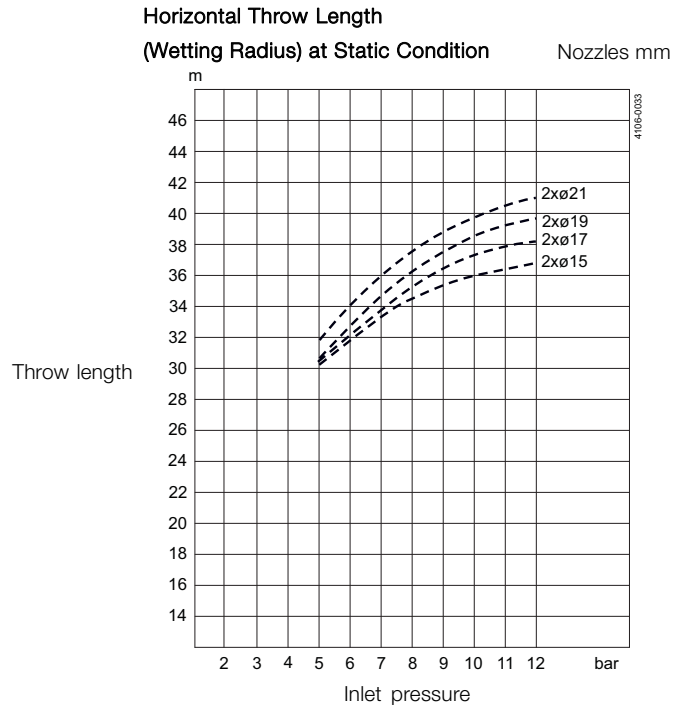
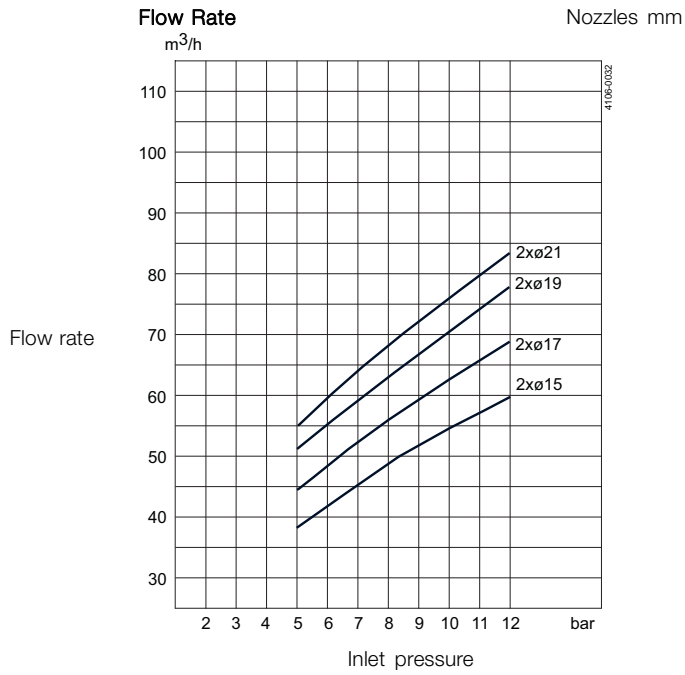

### Dimensions (mm)

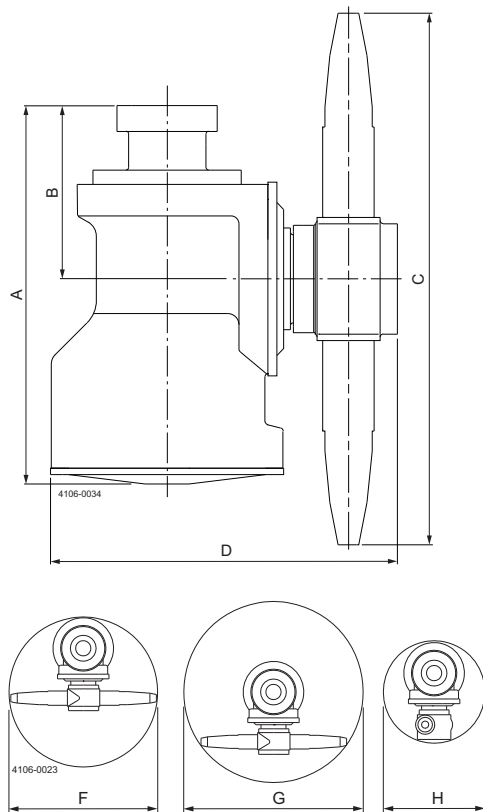

### Cleaning Time, Complete Pattern

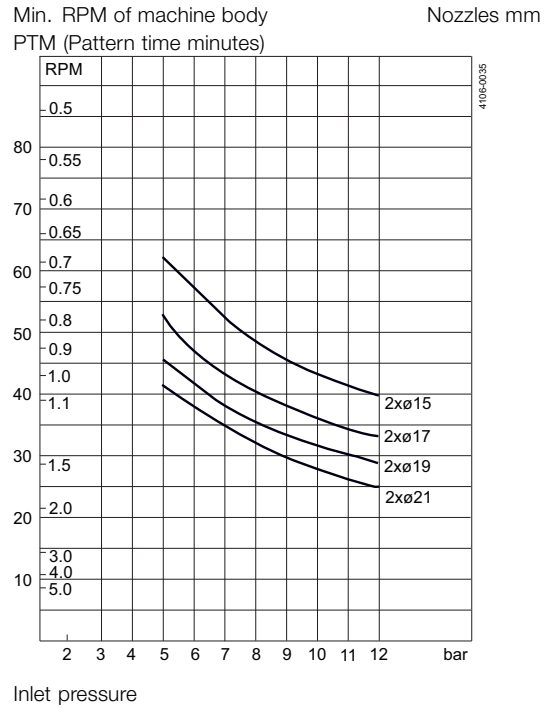

A	B	C	D	F	G	H
242	110	337	220	ø343	ø424	ø223

Alfa Laval reserves the right to change specifications without prior notification.



**ALFA ENGENHARIA**

Rua Dom Pedro Henrique de Orleans e Bragança, 809 - CEP 05117-002 - Vila Jaguara - São Paulo-SP  
[www.alfaengenharia.com.br](http://www.alfaengenharia.com.br) - [contato@alfaengenharia.com.br](mailto:contato@alfaengenharia.com.br)  
Tel: +55 11 3644-5476