

# Alfa Laval MultiJet 40

## Rotary jet heads

### Introduction

The Alfa Laval MultiJet 40 is a rotary jet head tank cleaning machines for use in industrial environments. Built to clean tanks with capacities from 50 and 500 m<sup>3</sup> it combines pressure and flow to create high-impact cleaning jets that rotate in a repeatable and reliable 360-degree cleaning pattern.

The MultiJet 40 minimizes the consumption of water, and cleaning media. Easy to customize to meet customer requirements, it allows companies to spend less time cleaning and more time producing.

### Application

The Alfa Laval MultiJet 40 is designed for the removal of the toughest residues from industrial tanks across a broad range of industries, such as the home care, chemical, pulp and paper, ethanol, starch, oil, and transportation industries.

### Benefits

- 60% faster cleaning = more time for production
- Saves up to 70% of your cleaning cost
- Eliminates the need for confined space entry for manual tank cleaning
- High-impact cleaning in a 360° repeatable cleaning pattern
- Cleaning process can be validated using Alfa Laval Rotacheck

### Standard design

The choice of nozzle diameters can optimize jet impact length and flow rate at the desired pressure. A 2.1 material certificate and an ATEX certification are available.

Alfa Laval offers a wide range of tank cleaning machines suitable for different duties and industries. An alternative that offers performance similar to the Alfa Laval MultiJet 40 is the Alfa Laval GJ 8 for applications that require a small tank inlet opening.

The above drawings show the cleaning pattern achieved on a cylindrical horizontal vessel. The difference between the first cycle and the full pattern represents the number of additional cycles available to increase the density of the cleaning.



### Working principle

The high-impact jet stream from the Alfa Laval MultiJet 40 rotary jet head covers the entire surface of the tank interior in a successively denser pattern. This achieves a powerful mechanical impact with a low volume of water and cleaning media.

The flow of the cleaning fluid makes the nozzles perform a geared rotation around the vertical and horizontal axes. In the first cycle, the nozzles lay out a coarse pattern on the tank surface. The subsequent cycles gradually make the pattern denser until at full cleaning pattern is reached.

Once the full cleaning pattern is reached, the machine will start over again and continue to perform the next full cleaning pattern.

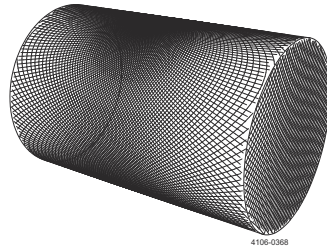
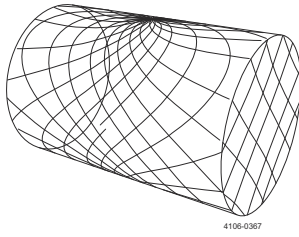

### Certificates

2.1 material certificate and ATEX.



First cycle

Full pattern

### TECHNICAL DATA

Lubricant:	Self-lubricating with the cleaning fluid
Max. throw length:	2 nozzles: 22 - 31 m
	4 nozzle: 8 - 17 m
Impact throw length:	2 nozzles: 11 - 18 m
	4 nozzles: 4 - 10 m

### Pressure

Working pressure:	2 nozzles: 2 - 12 bar
	4 nozzles: 3 - 12 bar
Recommended pressure:	2 nozzles: 5 - 10 bar
	4 nozzles: 5 - 6.5 bar

### PHYSICAL DATA

#### Materials

316L (UNS S31603), PTFE, PEEK, ETFE, FPM, TFM

#### Surface finish

Exterior finish:	Glass blasted
------------------	---------------

#### Temperature

Max. working temperature:	95 °C
Max. ambient temperature:	140 °C

Weight:	2 nozzles: 6.5 kg
	4 nozzles: 6.1 kg

#### Connections

Standard female thread:	1½" Rp (BSP) or 1½" NPT
-------------------------	-------------------------

### Caution

Avoid hydraulic shock, hard and abrasive particles in the cleaning liquid, as this can cause increased wear and/or damage of internal mechanisms. In general, a filter in the supply line is recommended. Do not use for gas evacuation or air dispersion. For steaming we refer to the manual.

## PERFORMANCE DATA, 4 NOZZLES

### Flow rate

m<sup>3</sup>/h

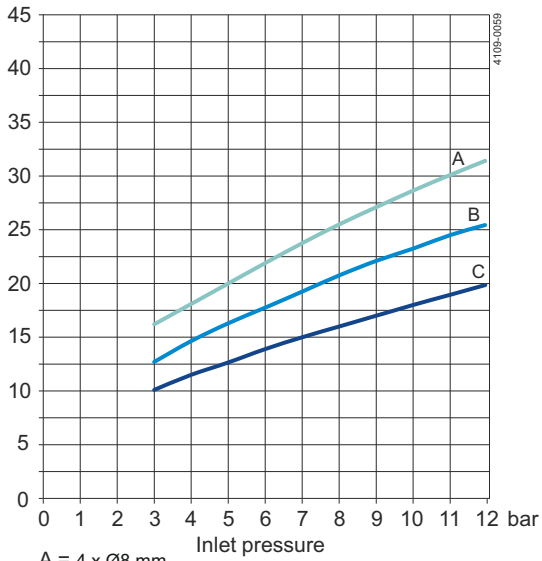

A = 4 x Ø8 mm  
 B = 4 x Ø7 mm  
 C = 4 x Ø6 mm

### Impact Throw Length

m

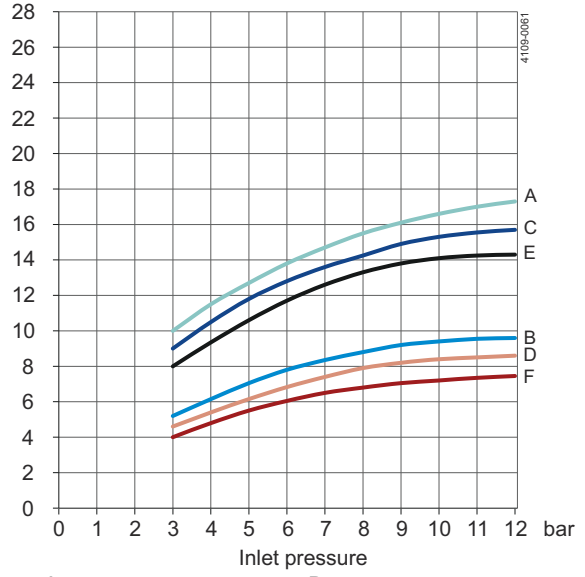

A = 4 x Ø8 mm, Max static    D = 4 x Ø7 mm, Effective  
 B = 4 x Ø8 mm, Effective    E = 4 x Ø6 mm, Max static  
 C = 4 x Ø7 mm, Max static    F = 4 x Ø6 mm, Effective

### Cleaning Time, Complete Pattern

Min. RPM of machine body

[sec] [min]

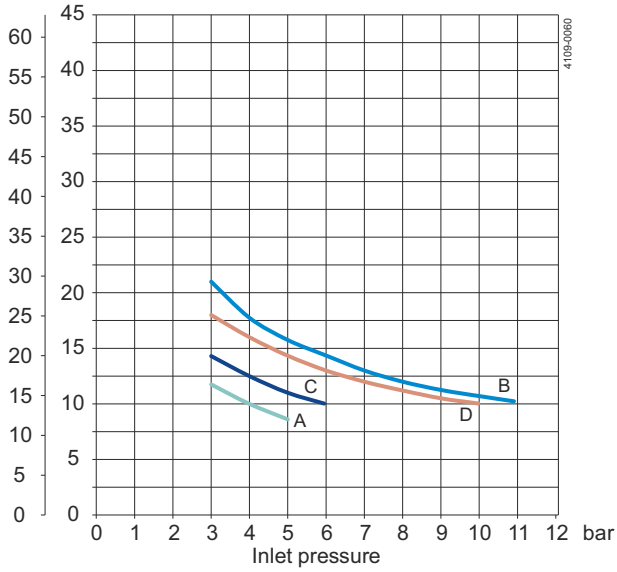

A = 4 x Ø8 mm, 100%    C = 4 x Ø7 mm, 100%  
 B = 4 x Ø8 mm, 0%    D = 4 x 6 Ømm, 100%

## PERFORMANCE DATA, 2 NOZZLES

### Flow rate

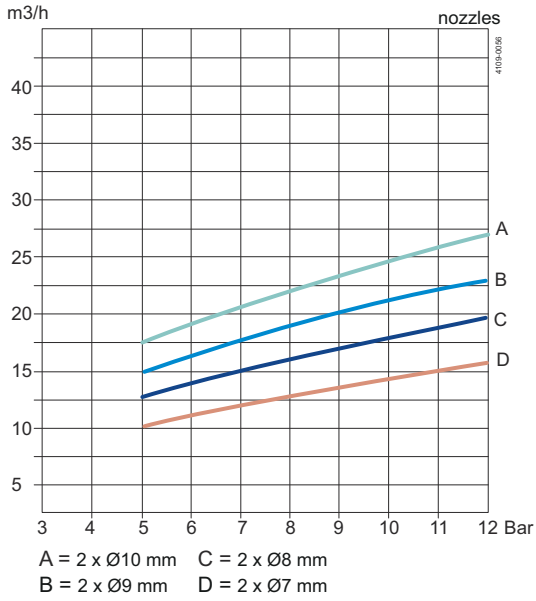

### Impact Throw Length

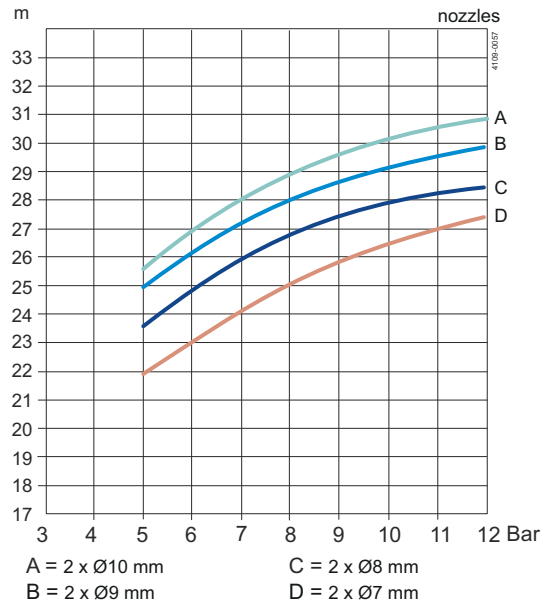

— Max. static

### Cleaning Time, Complete Pattern

Min. RPM of machine body

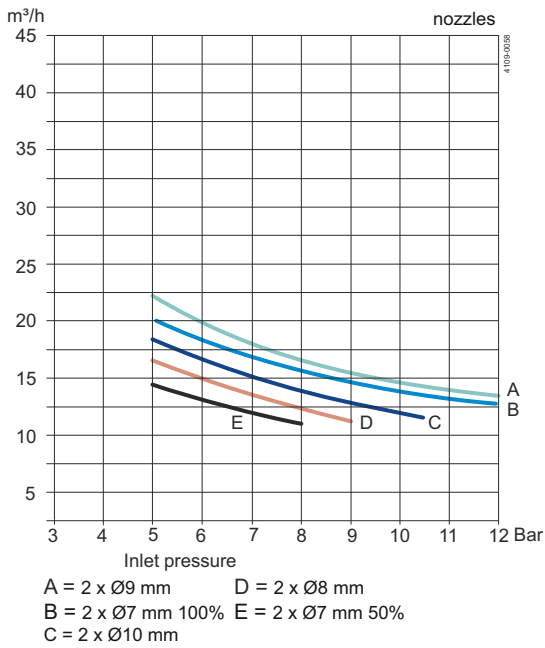

Dimension(mm)

2 nozzle version

4 nozzle version

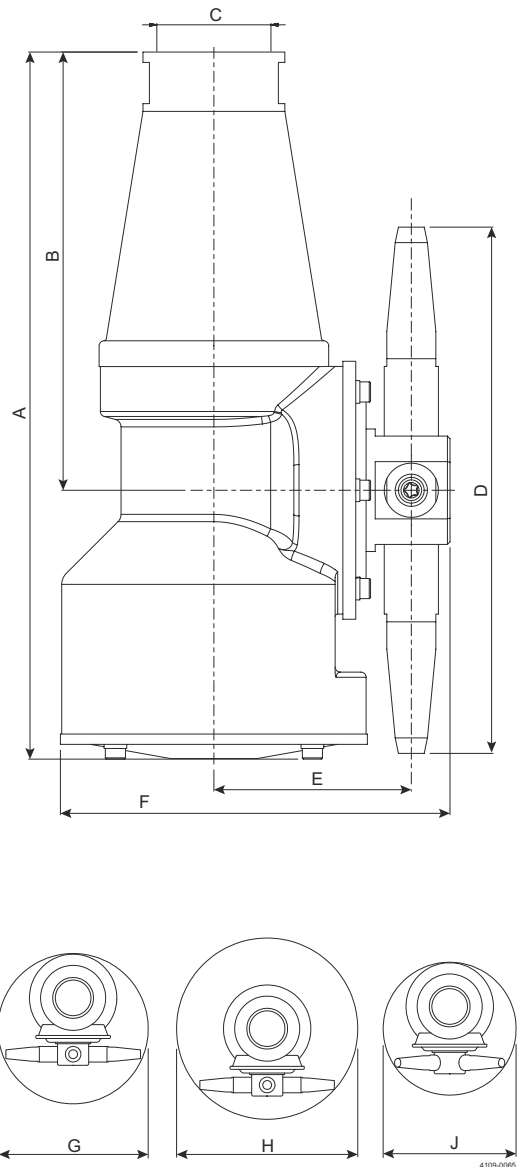
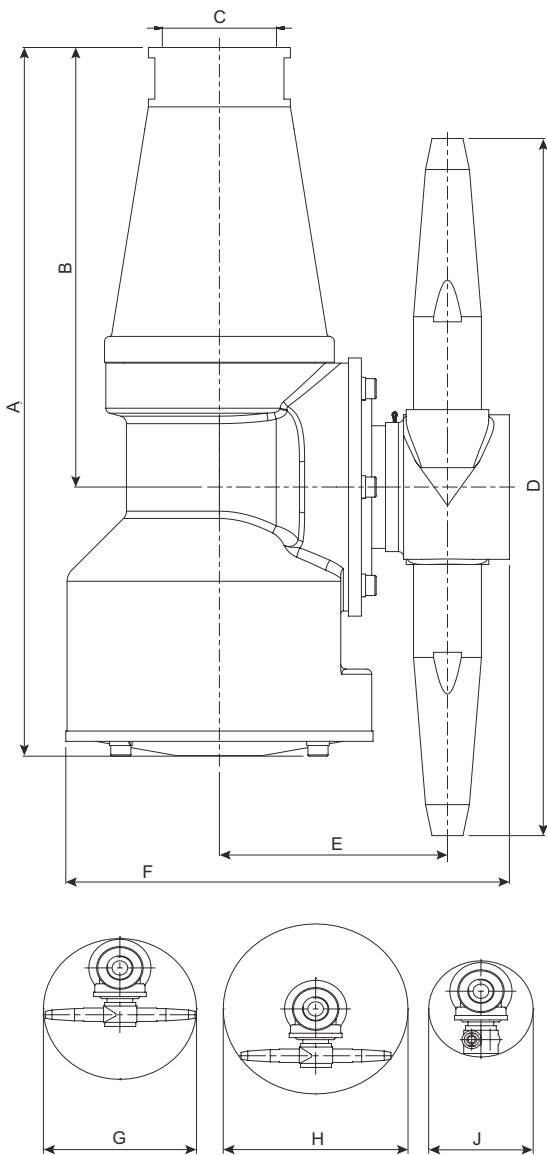

2 nozzles

A	B	C	D	E	F	G	H	J
274	170	1½" BSP or 1½" NPT	270	88	172	Ø274	Ø333	Ø176

4 nozzles

A	B	C	D	E	F	G	H	J
297	170	1½" BSP or 1½" NPT	204	78	152	Ø216	Ø264	Ø180

Qualification Documentation

Documentation specification

ATEX	ATEX approved machine for use in explosive atmospheres Category 1 for installation in zone 0/20 in accordance with Directive 2014/34/EU II 1G Ex h IIC 85 °C ... 175 °C Ga II 1D Ex h IIC T85 °C ... T140 °C Da
------	--

## TRAX simulation tool

TRAX is a unique software that simulates how the Toftejorg MultiJet 40 performs in a specific tank or vessel. The simulation gives information on wetting intensity, pattern mesh width and cleaning jet velocity. This information is used to determine the best location of the tank cleaning machine and the correct combination of flow, time and pressure to implement.

A TRAX demo containing different cleaning simulations covering a variety of applications can be used as reference and documentation for tank cleaning applications. A TRAX simulation is free and available upon request.

### Wetting Intensity

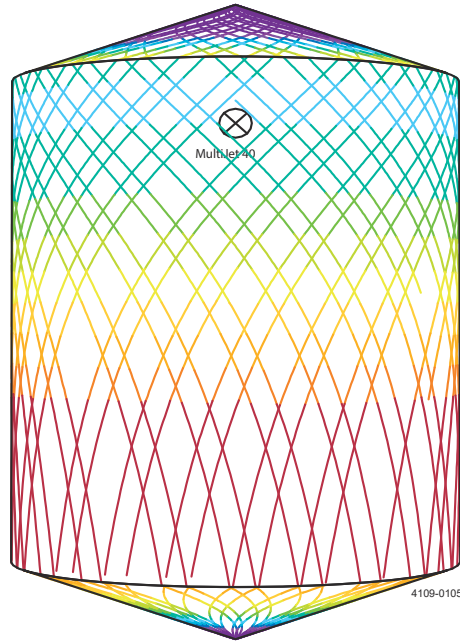
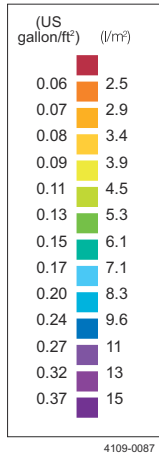

D5 m H6 m, Toftejorg MultiJet 40, 4 x Ø6 mm, 100% Time = 4.3 min, Water consumption = 887 l

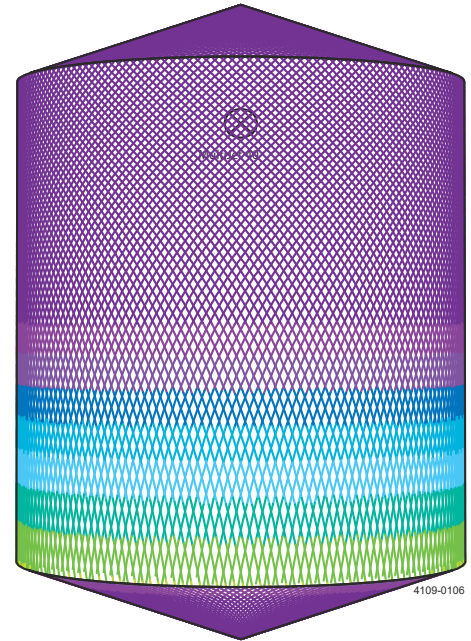

D5 m H6 m, Toftejorg MultiJet 40, 4 x Ø6 mm, 100% Time = 18.2 min, Water consumption = 3760 l

This document and its contents are subject to copyrights and other intellectual property rights owned by Alfa Laval Corporate AB. No part of this document may be copied, re-produced or transmitted in any form or by any means, or for any purpose, without Alfa Laval Corporate AB's prior express written permission. Information and services provided in this document are made as a benefit and service to the user, and no representations or warranties are made about the accuracy or suitability of this information and these services for any purpose. All rights are reserved.